

**GBP**

[www.gbplastics.co.uk](http://www.gbplastics.co.uk)

***SPEEDY TILE***



---

# PRODUCT GUIDE

*The thermal lightweight replacement roof tile*

## LIGHT WEIGHT ROOF TILE



The faster to fit large coverage slate effect thermal roof tile

Just 5 sheets per m<sup>2</sup> @ 14-25 degrees pitch - 4 sheets per m<sup>2</sup> @ 25+ degrees pitch (30% less than leading brand)

8.5kg per m<sup>2</sup> (32% less than leading brand)

20 year guarantee

0.17 Thermal U Value

Uv, Deluge Wind and Rain, BS 476 Part 3 Fire Tests all passed

Manufactured to ISO 9001

Available in Grey, Brown & Terracotta plus any other colour is available upon request

No need for a starter row due to innovative patented drain channel saving approx. 20 leading brand tiles on 6m run

## PRODUCT INFORMATION



### Tools Required:

No special tools required for the installation of the tiles.

- Fastened with either screws or nails, using power drill, hammer or neumatic nail gun
- Circular Saw or Hand Saw
- Tape Measure

### Fastener Recommendations

Tiles should be applied to the roof using two galvanised stainless steel or copper fasteners (nail or screw) with a minimum of a 10mm diameter head and ranging between 20mm and 30mm in length. Screwing is recommended to a torque of 10 using a flat head self drilling screw.

### Product Description

Speedy Tile is manufactured from a recyclable blend polypropylene and fire resistant and UV additives. The product designed to be an efficient and economical lightweight alternative to emulate the classic slate roof tile.

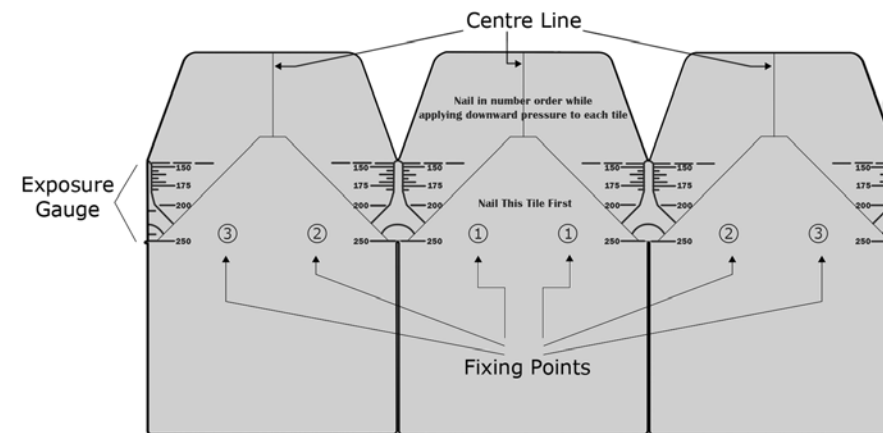

### Measurements

|                       |   |        |
|-----------------------|---|--------|
| Total Width           | - | 1000mm |
| Individual Tile Width | - | 330mm  |
| Height                | - | 500mm  |
| Tile Depth            | - | 5mm    |
| Weight                | - | 1.5kg  |

## PRODUCT INFORMATION



### Storage

Perform work when existing and forecasted weather permits. Store the tiles on the original pallets on a flat surface. Ensure proper storage of the product at the site of the job. Storing during cold weather, the tiles should be conditioned at a temperature no lower than 7°C for 24 hours before installation.

### Product Ratings and Certifications

Warranty: 20 Years

Manufactured to ISO 9001 standards

Weather and Fire tested by BRE

Fire Classification: Tested to BS 476 part 3 "external fire exposure to roofs" and achieved a rating of EXT.S.AC

The tiles were weather tested at roof pitches of 25°, 22.5° and 15°. The tests were carried out using a monopitch roof test rig according to the procedures in CEN standard FprEN 15601.

Two sets of test conditions used:

Sub Test B - High rainfall with high wind speed

Sub Test D - Deluge - Simulating maximum rainfall with no wind

These test conditions represent typical worst case conditions expected in Northern Europe during a 50 year return period

The Speedy Tile's performance was compared with natural slate, fibre cement and flat tiles tested at the same pitch to which the test results were twice as good as the other materials.

Heat tested by Exova - Taken from -10°C up to 30°C over a six hour period to simulate direct sunlight on a roof over a day, then reverse tested back down to -10°C. After temperature profile complete, the tiles were returned to 23°C for 15 hours. Over the course of testing, there was no detrimental warping, bowing or distortion seen from ambient condition and no visual permanent deformation had occurred to the tiles in comparison to their prior testing condition.

No Ultra Violet Exposure - Minimal fading with no evidence of cracking, chalking, flaking, blistering or other deterioration other than the slight colour and gloss change

### Recycling

Speedy Tile is 100% recyclable, although not marked with a recycling symbol therefore a local recycler should be contacted to make the necessary arrangements.



## INSTALLATION



The starter course does not require double tiling with Speedy Tiles all the way along the base. Instead drain channels will need to be attached to cover fill the space in between the tiles and allow water to run into the gutter. Only double tile the very end of the course if the drain channel is unable to properly connect to the internal V of the tiles. Tile Clips are a recommended addition to the roof to remove any chance of lift in strong winds. See the next page for fitting instructions.

### Felt and Batten Roof

There is not much difference in the Speedy Tile to standard slate tiles apart from the weight of our product and it is more ergonomic.

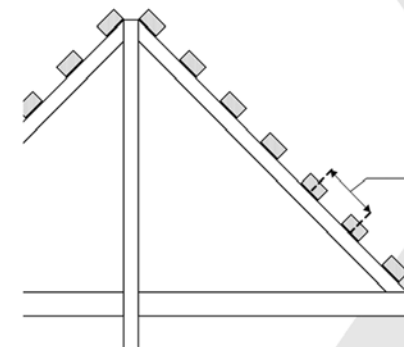

Batten placement is dependant on pitch of the roof, measurement is from centre line to centre line of the batten:

|            |   |       |
|------------|---|-------|
| 14° to 25° | - | 200mm |
| 25°+       | - | 250mm |

Tiles oversail the battens

### Roof Pitch, Gauge and Coverage

| Roof Pitch (Fully Boarded or Felt & Battens) | Gauge | Slates per M <sup>2</sup> |
|--|-------|---------------------------|
| 14 to 25 degrees                             | 200mm | 15                        |
| 25+ degrees                                  | 250mm | 12                        |

## INSTALLATION



Ridge Cap -

Top Course of Tiles must be covered by the Ridge Cap

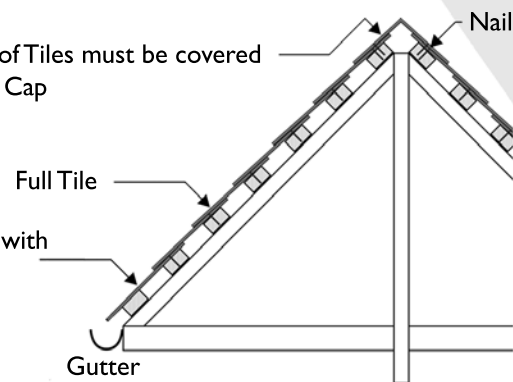

The first batten is positioned at the base of the roof for supporting the tiles. No tiles will be attached to this batten. The distance between each course batten should be established by the roof pitch. The position of the top battens should then be established to ensure the top course of tiles will be covered by the ridge cap.

The starter course should oversail the fascia by at least 40mm

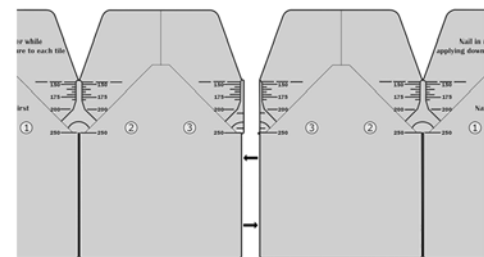

The Speedy Tile sits flush, lined up with the exposure gauges on each product. The exposure gauges are measurement marks to help with the alignment of the tiles.

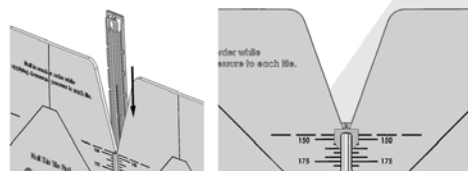

The Tile Clip is used for roofs in coastal areas or places that receive strong winds as an added secure feature. The bottom half of the clip slides in between two adjacent tiles with the top half hooking into the centre of the top tile.

The Drain Channel is attached by sliding down the back of the of the Speedy Tile and clipping in the V that identifies the individual tiles within the product.

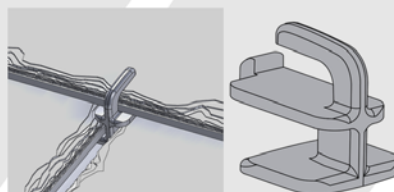

## STARTER COURSE

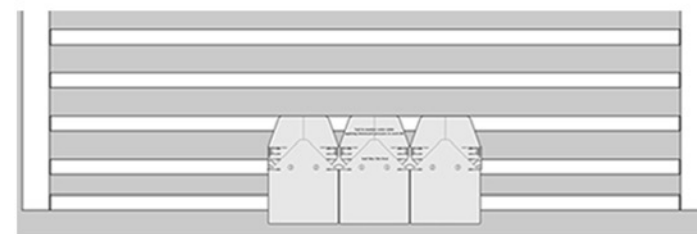

When laying the Speedy Tile, start in the middle of the roof and work outwards. Work from one side across if the roof facet has a verge at one end and a ridge at the other end. Working from the bottom on the starter course then build upwards

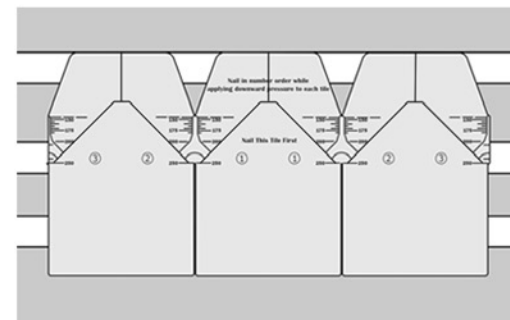

On the starter course of tiles, start by fastening the Speedy Tile in fixing points 1, then fixing points 2. Secure the tile in place with the recommended screws and screwdriver to a Torque of 10

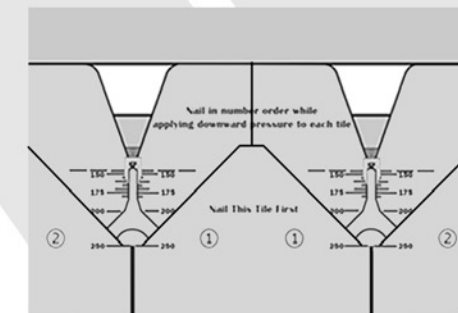

Attach the Drain Channels to the internal V's of all the Speedy Tiles that will be on the starter course before fixing the product to the roof structure

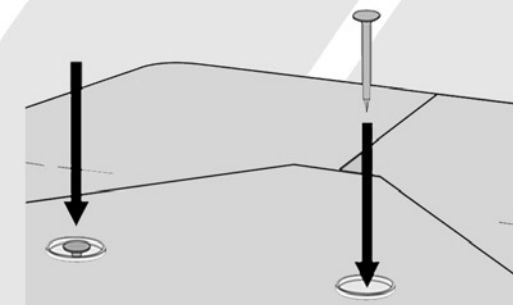

## Starter Course

**SPEEDY TILE** 

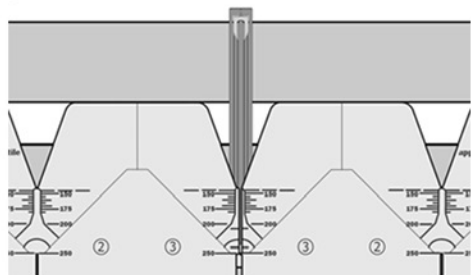

Attach the Drain Channel to the adjoining tiles, making sure it is clipped in and flush with both parts

Once the Drain Channel is connected to the Speedy Tiles, fasten down fixing points 3 to the roof

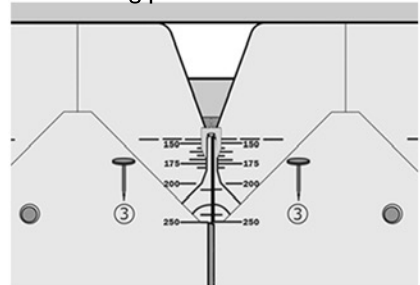

Next line up the Speedy Tiles adjacent to the already fixed tile and attach to the roof in fixing points 1, and then fixing points 2 on the Speedy Tile



Double Tile End

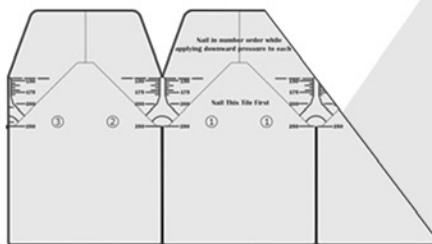

Apply Drain Channel

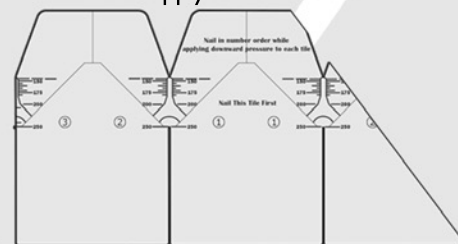

Double tile, the end slate of the starter course if a drain channel cannot be properly connected to the tiles between the V

## ADDITIONAL COURSES

**SPEEDY TILE** 

The exposure gauge determines how much of the previous tile can be visible

Line up required exposure mark with the top of previous tile

Edge of the tile aligns with centre line of the previous tile

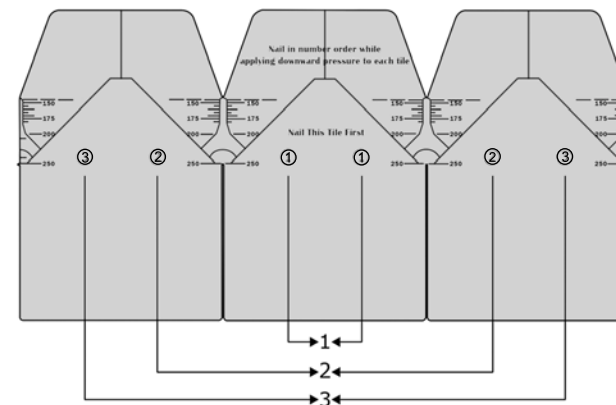
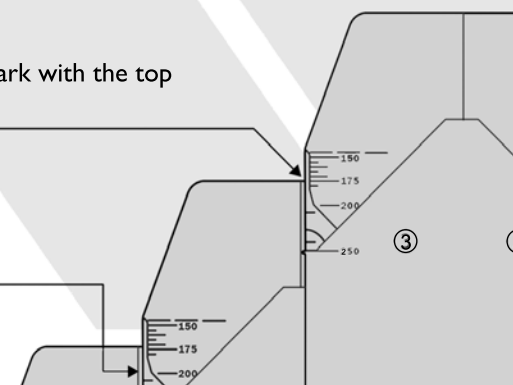

After the starter course has been laid and fixed down. Each of the Speedy Tiles should be attached to the roof one at a time, one course at a time, fastened in numerical order starting at fixing point 1, then 2 and finishing at fixing point 3. Apply pressure to the inside of each fixing point when securing to the roof.



## ADDITIONAL COURSES

**SPEEDY TILE** 

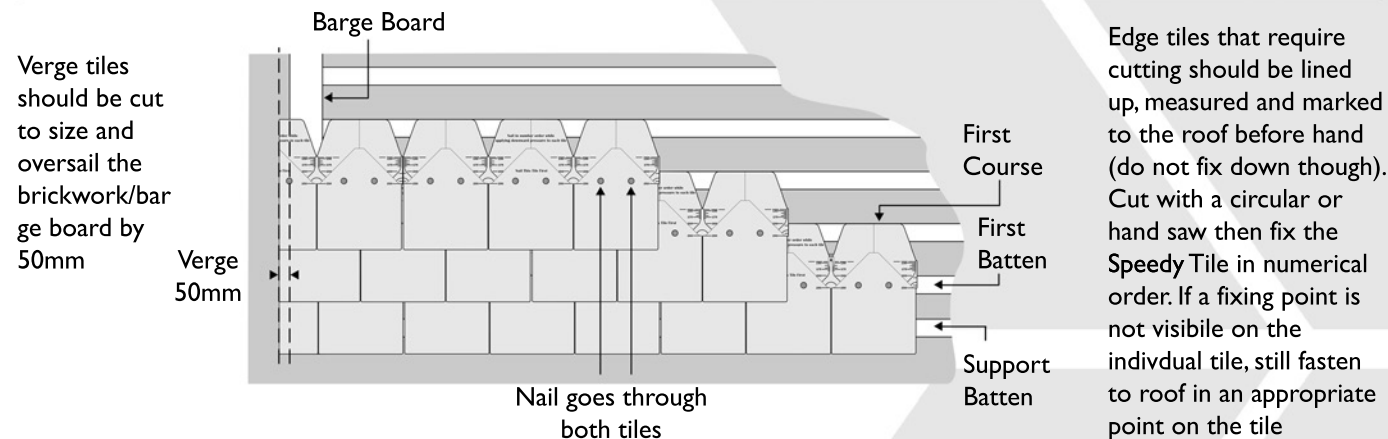

Tiles Should be cut to line up with the centre of the beam on a hip. Allowing the slate to be covered by the Hip and Ridge Cap

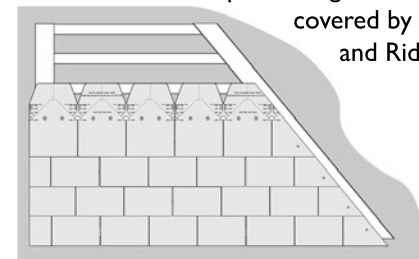

Top Course should be cut to line flush with the top batten

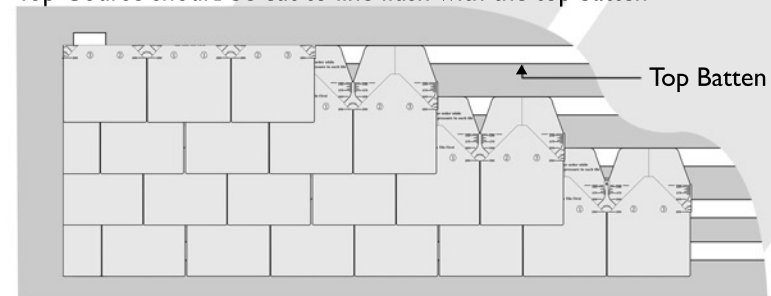

10

## Ridge Tile and End Cap

**SPEEDY TILE** 

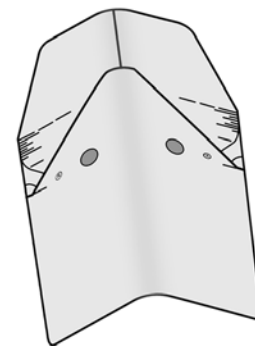

For the ridge, there are 3 tile options available for purchase: 90°, 110°, 120° depending on the roof requirements

Fix the ridge tile to the support beam on the roof at the points 'R' marked on the tile

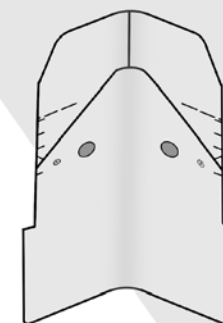
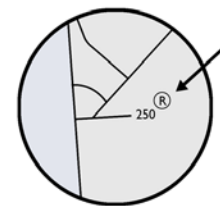

Cut the minimum amount required from the edge of the tile at the roofing gauge up to the top of the tile to give a cleaner finish of the ridge

If there is lift at the base of the ridge tiles, panel pins or a silicone adhesive are recommended to secure the ridge tiles

For capping the ridge tiles, there are two options. Option 1, cutting the base tile to match the shape of the roof. Option 2, purchase the Speedy Tile capped end ridge tile

(1)

(2)

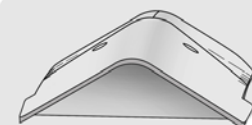

Starting at the bottom of the ridge fix the tiles working upwards and lay on top of each other as you go, ensuring all gaps underneath are covered by tiles

11

## TRIPLE TILE

**SPEEDY TILE** 

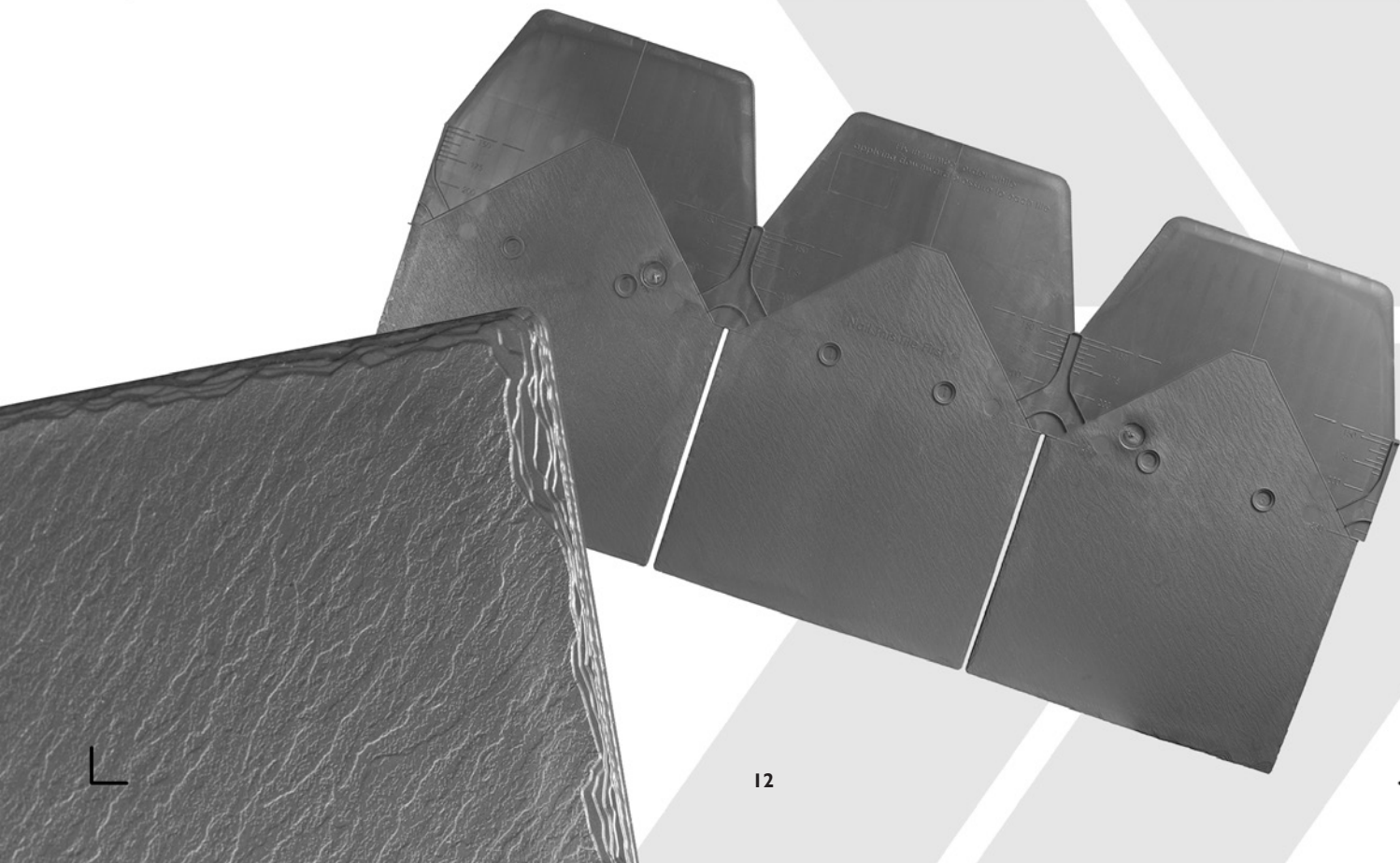

12

## DRAIN CHANNEL

**SPEEDY TILE** 



13

## RIDGE TILE

**SPEEDY TILE** 

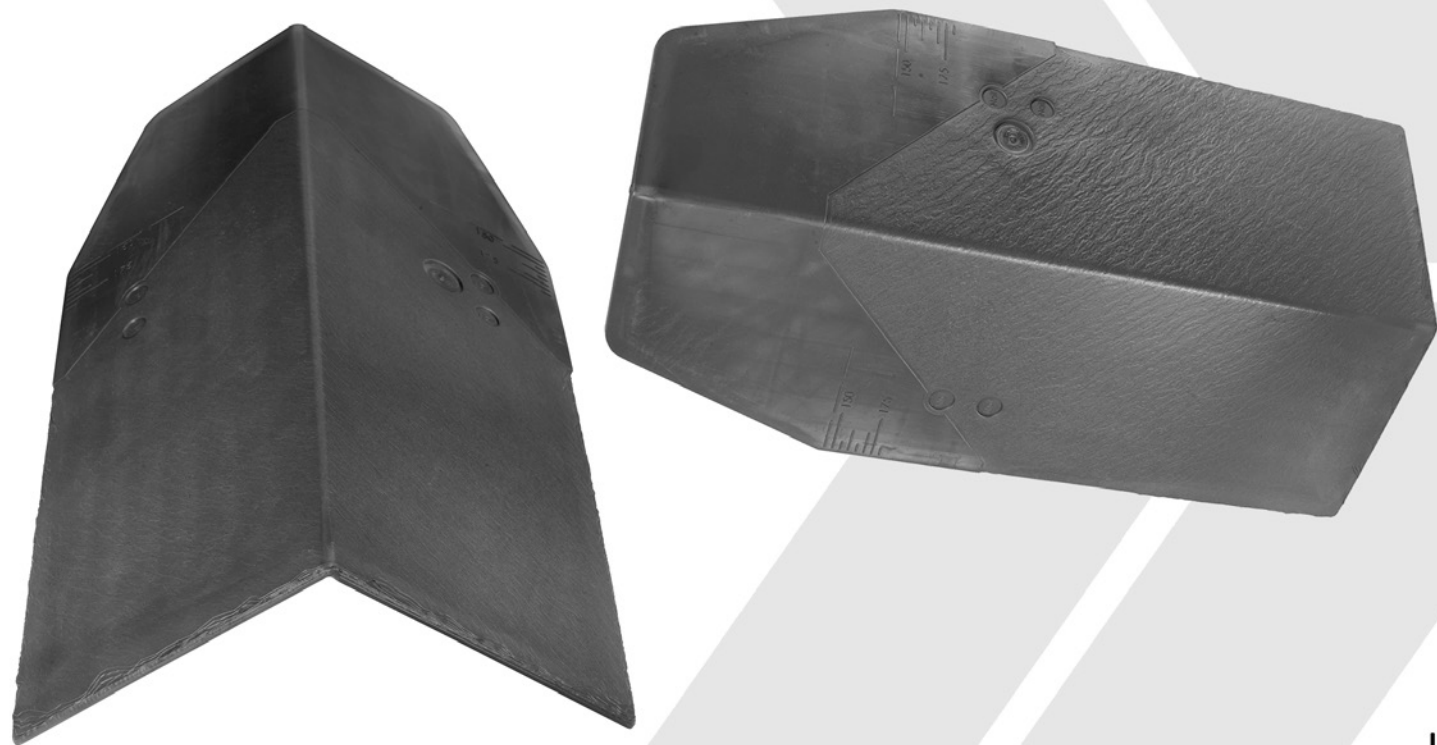

14

## TILE CLIP

**SPEEDY TILE** 



15